

SPECIFICATIONS

Dimensions	296 (W) x 305.5 (H) x 97.5 (D) mm, approx. 2.6 kg
Display	7" TFT wide LCD screen (800 x 480)
Recorder	Method: Thermal array print Type: Roll type Print speed: - Real time mode: 1, 2, 3 cm/min - Trace mode: 20, 30 cm/min Paper feeding function
Power	Input: 100 - 240 VAC, 1.5 - 0.7 A, 50 - 60 Hz / Output: 18 VDC, 2.8 A
Battery (Option)	Li-ion: 4 hours (charging) 2 hours (discharging)
External Link	LAN, WiFi, USB flash drive
Fetal Heart Rate	Input signal: Ultrasound pulsed doppler Ultrasound frequency: 1.0 MHz, 975 KHz Ultrasound power: < 10 mW/cm ² FHR detection method: Autocorrelation FHR range: 50 ~ 210 BPM FHR accuracy: 120 ~ 160 BPM: ±1 BPM / Except 120 ~ 160 BPM: ±2 BPM
Uterine Contraction	Input source: External transducer with load cell Reference control: One touch switch, auto zeroing Measurement range: 0 ~ 99
Fetal Movement Measurement	Detection source: Ultrasound pulsed doppler, event marker
Data Storage	Storage for 72 hours
Auto CTG Analysis	Average baseline FHR Number of UC Number of acceleration Number of deceleration Late deceleration Early deceleration Variable deceleration High episode Low episode Short term variability Signal loss *CTG Analysis results are printed out every 10 minutes. (Intermediate report)
Accessory (Standard)	Ultrasound doppler probe (2 ea), UC probe (1 ea), Event marker (1 ea), Print paper (2 rolls), Power adaptor & cord (1 ea), Ultrasound gel (1 ea), Probe belt (3 ea), Operation manual (1 ea), Stand (1 ea)
Accessory (Option)	Rechargeable battery (1 ea), Cart, USB WiFi Dongle

*Specifications are subject to change without prior notice.

*You may have distortion or signal noise when you use nonstandard or other brand's accessories. We strongly recommend you use only the authorized accessories which we supply.

Equipos Nuevos, a Precios Bajos
www.BeracahMedica.mx



201609-BionetBA (FC1400)-R1.2

North America (U.S.A): Bionet America, Inc.

E-mail: sales@BionetUS.com

Tel: +1-714-734-1760

www.BionetUS.com

South Korea: Bionet Co., Ltd

E-mail: sales@ebionet.com (Int'l)
ajy@ebionet.com (Domestic)

Tel: +82-70-7585-6418 (Int'l)
+82-2-6300-6483 (Domestic)

www.ebionet.com

Latin America: Bionet Latin America, Inc.

E-mail: bla@ebionet.com

Tel: +1-949-800-9585

www.bionetesp.com

Europ: MGB Endoskopische Geräte GmbH Berlin (Germany)

E-mail: sales@mgb-berlin.de

Tel: +49-30-6392-7000

www.mgb-berlin.de

China: Bionet China, Inc.

E-mail: sales-cn@ebionet.com

Tel: +86-70-4838-1301

www.ebionet.com



FC 1400

Antepartum Fetal Monitor for Twin Fetuses
7" Full Touch Screen Color TFT LCD



FC 1400 | Explore powerful functions and intuitive operations |



• **Yellow/Green LED alarm**
 Alarm lamp for easier recognition of device and patient status



• **Convenient USB function**
 memory storage, WiFi converter



• **7" color TFT LCD (800X480)**
 • **Touch screen operation**



• **10 smart keys for 16 functions**



• **More compact probe & robust connector**



• **Paper feeding for short handwriting memo**

➤ 2 Display Modes

- Graphic Mode: For general monitoring of fetal status
- Text Mode: For user's quicker & easier recognition of fetal status from long distance

• Graphic Mode

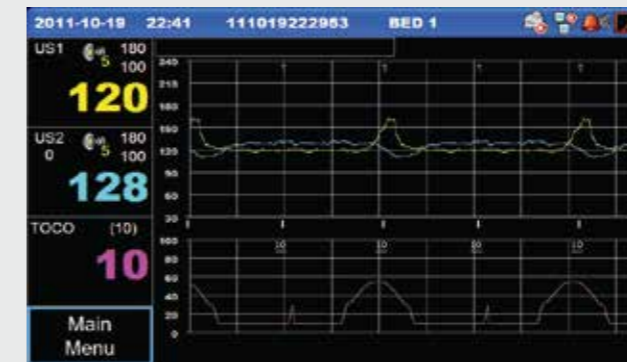

• Text Mode

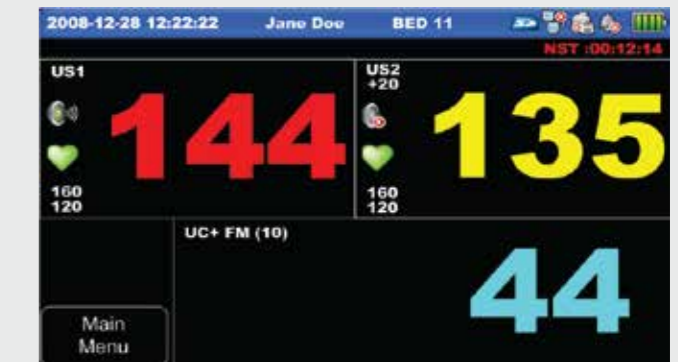

➤ CTG Interpretation Report

- For more comfortable and easier reading of findings by users.
- Up to 4 hours and 30 minutes data

EXIT	Patient	Trace	Alarm History	Print Start	Wave Print	Clinical mark
	Display	Network	Preset	Printer	System	Note
EXIT	NST Speed 3 c/min	Wave Speed N/A	NST :50Ma	CTG :On	Scale Interval	Grid :Off
Up	Size :B5					

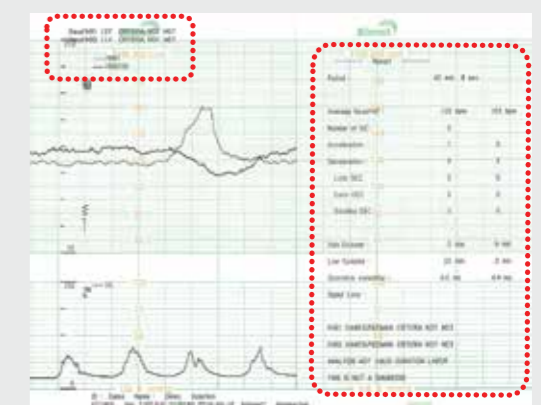

• 72-hour Storage and Exporting JPG to USB Flash Drive

- How to export JPG file to EMR using USB memory storage



For 10-minute interval screen (1 page) review, press the LCD screen

For 1-minute interval screen review, press the volume up keys (I or II)

For 6-second interval screen review, press the volume down keys (I or II)

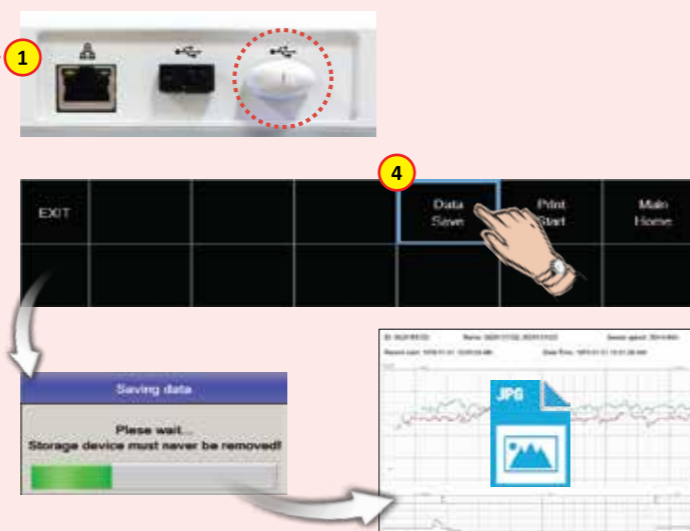

➤ Input Note from Note List

The note is shown in the status line of the display, and is annotated on the fetal trace. There are 4 default notes and maximum 100 notes can be documented by users.

1. Press the 'Print Start' key.

2. Press the 'Data Save' key.

3. Press the 'OK' key.

Select Note

Content
1 Patient Repositioned
2 Vaginal Examination
3 MD Notified
4 Sitting

UP DOWN OK Cancel

4. Press the LCD screen.